

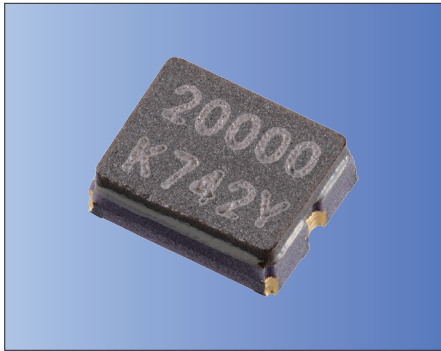

2.0×1.6mm for Automotive



AEC-Q200 RoHS Compliant

Features

- Crystal unit for automotive electronics
- Ultra-miniature and low profile (2.0×1.6×0.8mm)
- Ceramic package
- Reflow compatible
- Durable, all-ceramic package, ideal for applications involving resin or epoxy over coating.
- Acceptable heat cycle solder junction for 3000 cycles (-40 to +125°C)

Applications

- ECU
- Automotive Camera
- Radar

How to Order

CX2016GR 27000 D0 G T V CC
① ② ③ ④ ⑤ ⑥ ⑦

- ① Series
 - ② Frequency
 - ③ Load Capacitance
 - ④ Frequency Tolerance
 - ⑤ Operating Temp. Range
 - ⑥ Frequency Temp. Stability
 - ⑦ Individual Specification (STD Specification is "CC".)
- Table 1: D0 8 pF, G ±15×10⁻⁶
- Table 2: TV -40 to +150°C, ±150×10⁻⁶
- ⑦ Individual Specification (STD Specification is "CC".)
- Packaging (Tape & Reel 3000/ 15000 pcs./ reel)

Specifications

Item	Symbol	Specification	Unit	Remarks
Frequency Range	f _{nom}	16000 to 60000	kHz	
Overtone Order	OT	Fundamental	—	
Load Capacitance	CL	8	pF	Please contact us for other CL requirements.
Frequency Tolerance	f _{tol}	±50	×10 ⁻⁶	25°C±3°C
Motional Series Resistance	R1	Table 1	ohm	
Drive Level	DL	Table 2	μW	
Operating Temp. Range	T _{use}	-40 to +150	°C	
Storage Temp. Range	T _{stg}	-40 to +150	°C	
Frequency Temp. Characteristics	f _{tem}	±150	×10 ⁻⁶	Freq. deviation from the value at 25°C

Please contact us for other specifications.

Table 1 Motional Series Resistance

Frequency Range	Motional Series Resistance
16000 ≤ f _{nom} < 18000kHz	300 Ω max.
18000 ≤ f _{nom} < 20000kHz	200 Ω max.
20000 ≤ f _{nom} < 40000kHz	100 Ω max.
40000 ≤ f _{nom} ≤ 60000kHz	50 Ω max.

Table 2 Level of Drive

Frequency Range	Level of Drive
16000 ≤ f _{nom} < 60000kHz	10μW (200μW max.)

Dimensions

(Unit: mm)

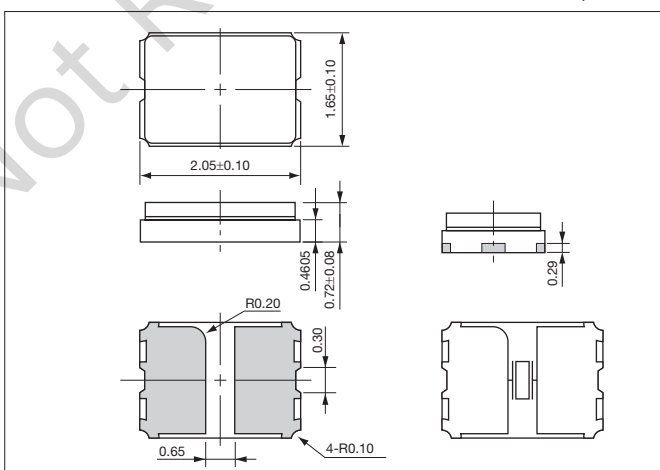

Recommended Land Pattern

(Unit: mm)

