

RoHS規制対応
 COMPLIANT WITH
 RoHS REGULATIONS

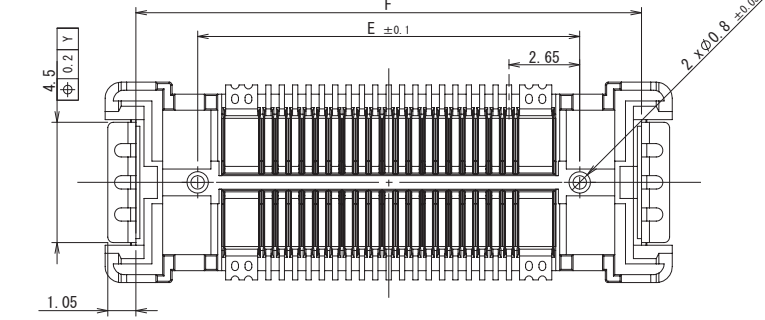
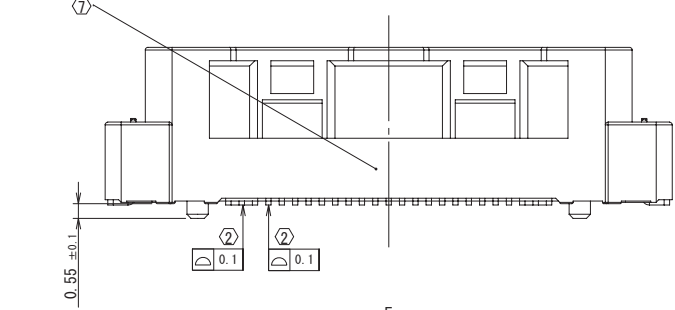
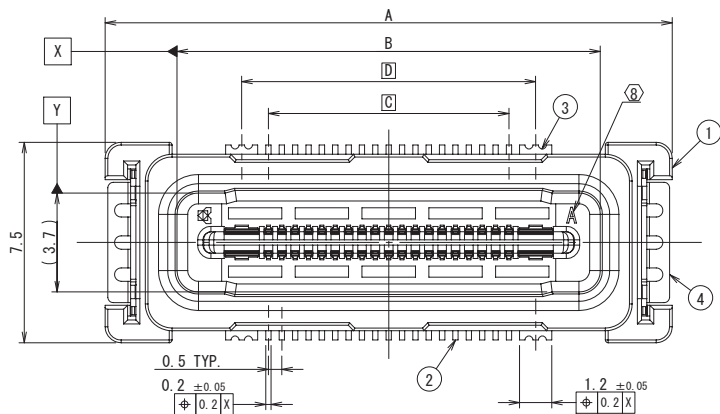

⑦ 図示の位置にLOT NO. を刻印する(6桁)。
 LOT NO. SHALL BE MARKED AT THE SPECIFIED
 POSITION. (6 DIGIT)

E 7 08 XX (例) 2025/07/08
 工場コード (FACTORY CODE)
 製造日 (DAY) 01, 02, ~29, 30, 31
 製造月 (MONTH) 1, 2, ~9, X, Y, Z
 製造年 (YEAR) 2020~2029: A, B, ~K (NOT USE "1")
 2030~2039: 0, 1, ~9 (20 YEAR CYCLE)

⑧ 図示の位置にCAVITY NO. を刻印する (A~)。
 CAVITY NO. SHALL BE MARKED AT THE SPECIFIED
 POSITION (A~)

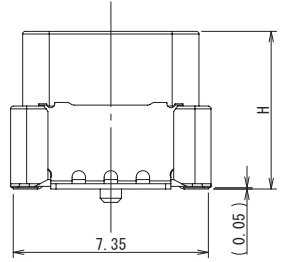

	H
H11	5.9
H14	8.9

NO.	DESCRIPTION	PART NO.	QTY	MATERIAL	DRW NO.	REMARKS
1	INSULATOR		1	HEAT RESIST RESIN		COLOR:BLACK UL 94V-0
2	CONTACT		XXX	COPPER ALLOY		Au PLATING
3	POWER CONTACT		4	COPPER ALLOY		Au PLATING
4	ANCHOR PLATE		2	COPPER ALLOY		Sn-Cu PLATING
5	VACUUM CAP OR TAPE		1	STAINLESS STEEL OR POLYIMIDE		130P以上 CAP 130P未満 TAPE

型番 P/N 14 5631 XXX XXX 829 + T 注記 NOTE
 極数 NO OF POS.
 バリエーション VARIATION
 高さ HEIGHT
 11 : H11
 14 : H14
 ボス / 電源ピン BOSS / PWR PIN
 2 : 無 WITHOUT BOSS, WITH PWR PIN 4PINS
 3 : 有 WITH BOSS, WITH PWR PIN 4PINS

めっきコード PLATING CODE
 829+ : Ni UNDER COAT 1~5μm
 CONTACT AREA : Au 0.1μm MIN.
 TAIL AREA : Au 0.03μm MIN.

- フローティング可動量 (可動側: REC) FLOATING RANGE (MOVABLE SIDE: REC)
 ピッチ方向 : ±0.5mm / PITCH DIRECTION
 スパン方向 : ±0.5mm / SPAN DIRECTION
 対角方向 : ±0.5mm / DIAGONAL
 高さ許容量 : ±0.5mm / HEIGHT RANGE
- コンタクトテール、金具輪郭部0.1mm MAX. CONTACT TAIL, ANCHOR PLATE COPLANARITY 0.1mm MAX.
- 使用時は、コネクタのみで基板を保持せずスペーサなど設置下さい。 IN ADDITION TO THE CONNECTOR, INSERT A SPACER OR SUCH BETWEEN THE MATED BOARD.
- フローティングを最大ストロークさせた後に再利用する場合は、事前に確認の上ご使用ください。 USE THE CONNECTOR ON THE CONFIRMATION WHEN REUSING AFTER HAVING LET IT STROKE FLOATING TO THE MAXIMUM.
- 片側だけで抜去 (嵌合) しないで下さい。可能な限り両サイド均等に抜去して下さい。 PLEASE DO NOT UNMATE (MATE) WITH ONLY ONE SIDE. PLEASE UNMATE AS EVENLY AS POSSIBLE ON BOTH SIDES.
- 吸着CAP、肉盗み等外觀形状は変更の可能性があります。 THE VACUUM TAPE AND THE SHAPE OF INSULATOR SUCH AS DENT ARE SUBJECT TO CHANGE.

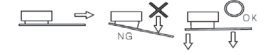

※この注記は1ページ目のみ適用。
 ※THIS NOTE IS APPLICABLE TO SHEET-1 ONLY.

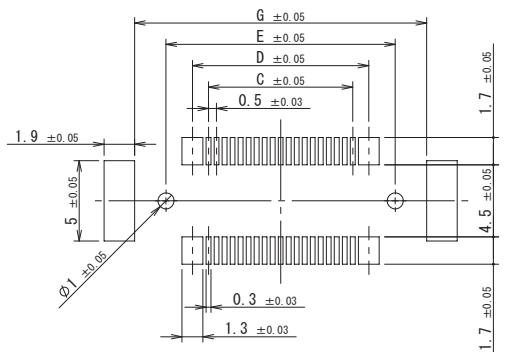

APPLICABLE PCB DIMENSION (REF.)
 適合基板寸法 (参考)

Pin Num.	A	B	C	D	E	F	G
SIG 18PINS + PWR4PINS ≒ 30PINS	16.22	10.84	4.0	6.0	9.3	13.92	13.22
SIG 38PINS + PWR4PINS ≒ 50PINS	21.22	15.84	9.0	11.0	14.3	18.92	18.22
SIG 58PINS + PWR4PINS ≒ 70PINS	26.22	20.84	14.0	16.0	19.3	23.92	23.22
SIG 78PINS + PWR4PINS ≒ 90PINS	31.22	25.84	19.0	21.0	24.3	28.92	28.22
SIG 98PINS + PWR4PINS ≒ 110PINS	36.22	30.84	24.0	26.0	29.3	33.92	33.22
SIG 118PINS + PWR4PINS ≒ 130PINS	41.22	35.84	29.0	31.0	34.3	38.92	38.22
SIG 138PINS + PWR4PINS ≒ 150PINS	46.22	40.84	34.0	36.0	39.3	43.92	43.22
SIG 158PINS + PWR4PINS ≒ 170PINS	51.22	45.84	39.0	41.0	44.3	48.92	48.22
SIG 164PINS + PWR4PINS ≒ 176PINS	52.72	47.34	40.5	42.5	45.8	50.42	49.72

TOLERANCE / 一般公差(S)		PRODUCT SPEC / 製品規格		A		DCN25534		2025/11/07		H.LU		-		F. IKEGAMI	
10 ≤ X < 30	±0.2	UNIT	ANGLE	0	EDN25174	2025/10/24	H.LU	-	F. IKEGAMI						
X < 10	±0.25	mm	3RD												
30 ≤ X	±0.3	SCALE	DATE												
ANGLE / 角度	±3°	NTS	2025/10/24												
DRAWN	DESIGNED	CHECKED	APPROVED	PART NAME / 品名											
M. TAKAHASHI	H. LU	-	F. IKEGAMI	SERIES 5631 PLUG ASSY ST SMT											
				0.5mm PITCH FLOATING BOARD TO BOARD											
				PART NO. / 型番											
				14 5631 XXX XXX 829 + T											
				DWG. NO. / 図番											
				BJS 5631006											
										SHEET	REV				
										1/3	A				

設計技術部
 '25.11.14
 発行

NO.	DESCRIPTION	PART NO.	QTY	MATERIAL	DRW NO.	REMARKS
-----	-------------	----------	-----	----------	---------	---------

RoHS規制対応
COMPLIANT WITH
RoHS REGULATIONS

吸着CAP仕様 (130PINS~)
VACUUM CAP

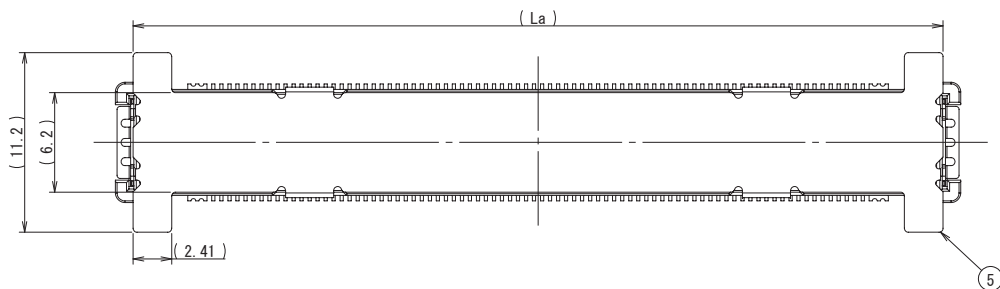

	Ha
H11	6.05
H14	9.05

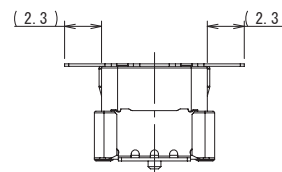

吸着テープ仕様
VACUUM TAPE

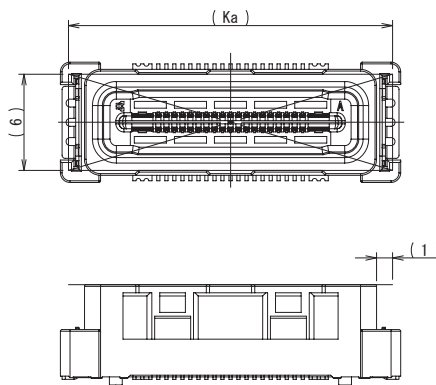

Pin Num.	La	Ka
SIG 18PINS + PWR4PINS ≒ 30PINS	-	15.22
SIG 38PINS + PWR4PINS ≒ 50PINS	-	20.22
SIG 58PINS + PWR4PINS ≒ 70PINS	-	25.22
SIG 78PINS + PWR4PINS ≒ 90PINS	-	30.22
SIG 98PINS + PWR4PINS ≒ 110PINS	-	35.22
SIG 118PINS + PWR4PINS ≒ 130PINS	38.02	-
SIG 138PINS + PWR4PINS ≒ 150PINS	43.02	-
SIG 158PINS + PWR4PINS ≒ 170PINS	48.02	-
SIG 164PINS + PWR4PINS ≒ 176PINS	50.52	-

設計技術部
'25.11.14
発行

TOLERANCE / 一般公差(S)		PRODUCT SPEC / 製品規格		REFER TO SHEET 1/3					
$X < 10$	± 0.2	UNIT	ANGLE	NO.	EDN/DCN	DATE	ISSUE	CHECKED	APPROVED
$10 \leq X < 30$	± 0.25	mm	3RD	PART NAME / 品名					
$30 \leq X$	± 0.3	SCALE	DATE	SERIES 5631 PLUG ASSY ST SMT					
ANGLE / 角度	$\pm 3^\circ$	NTS	2025/10/24	0.5mm PITCH FLOATING BOARD TO BOARD					
DRAWN	DESIGNED	CHECKED	APPROVED	PART NO. / 型番					
M. TAKAHASHI	H. LU	-	F. IKEGAMI	14 5631 XXX XXX 829 + T					
DWG. NO. / 図番				SHEET		REV			
KYOCERA				BJS 5631006		2/3		A	

RoHS規制対応
COMPLIANT WITH
RoHS REGULATIONS

NO.	DESCRIPTION	PART NO.	QTY	MATERIAL	DRW NO.	REMARKS
1	CONNECTOR	14 5631 XXX XXX 829 + T	N			10 5631 XXX XXX 829 + T
2	EMBOSS TAPE		1	POLYSTYRENE		
3	TOP COVER TAPE		1	PET		
4	REEL		1	POLYSTYRENE		

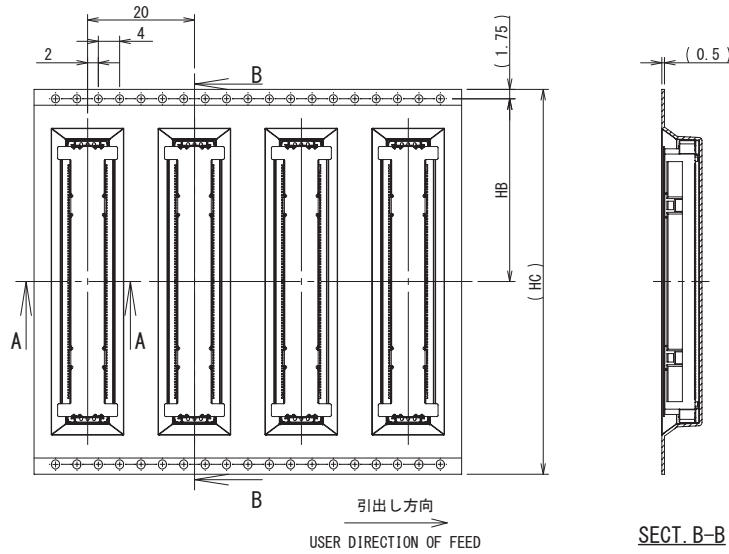

	HH	N
H11	7.5	600
H14	10.5	400

注記
NOTE

- 梱包数量：N個/リール
PACKING QUANTITY：N ea/reel
- 納入時のリール巻き方向
REELING DIRECTION IN DELIVERY
- 引出し方向
USER DIRECTION OF FEED

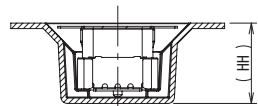
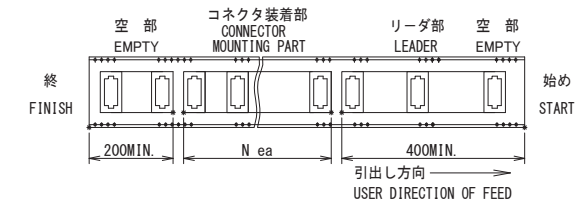
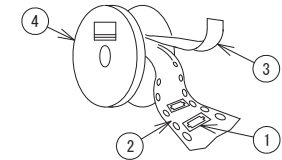

SECT. A-A
(S=2:1)

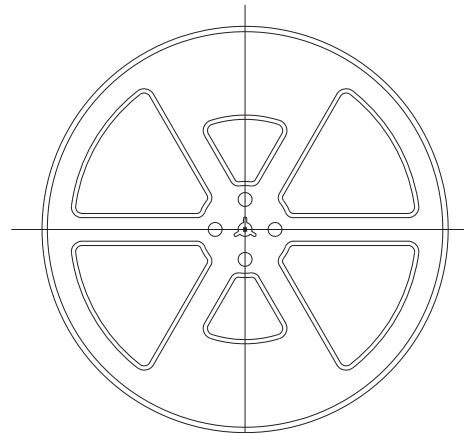

REEL DIMENSION

設計技術部
'25.11.14
発行

Pin Num.	HB	HC	HD
SIG 18PINS + PWR4PINS ≒ 30PINS	20.2	44.0	50.4
SIG 38PINS + PWR4PINS ≒ 50PINS	20.2	44.0	50.4
SIG 58PINS + PWR4PINS ≒ 70PINS	20.2	44.0	50.4
SIG 78PINS + PWR4PINS ≒ 90PINS	26.2	56.0	62.4
SIG 98PINS + PWR4PINS ≒ 110PINS	26.2	56.0	62.4
SIG 118PINS + PWR4PINS ≒ 130PINS	34.2	72.0	78.4
SIG 138PINS + PWR4PINS ≒ 150PINS	34.2	72.0	78.4
SIG 158PINS + PWR4PINS ≒ 170PINS	34.2	72.0	78.4
SIG 164PINS + PWR4PINS ≒ 176PINS	34.2	72.0	78.4

TOLERANCE / 一般公差(S)		PRODUCT SPEC / 製品規格		REFER TO SHEET 1/3					
$X < 10$	± 0.2	UNIT	ANGLE	NO.	EDN/DCN	DATE	ISSUE	CHECKED	APPROVED
$10 \leq X < 30$	± 0.25	mm	3RD	PART NAME / 品名					
$30 \leq X$	± 0.3	SCALE	DATE	SERIES 5631 PLUG ASSY ST SMT					
ANGLE / 角度	$\pm 3^\circ$	NTS	2025/10/24	0.5mm PITCH FLOATING BOARD TO BOARD					
DRAWN	DESIGNED	CHECKED	APPROVED	PART NO. / 型番					
M. TAKAHASHI	H. LU	-	F. IKEGAMI	14 5631 XXX XXX 829 + T					
DWG. NO. / 図番				SHEET				REV	
KYOCERA				BJS 5631006				3/3 A	