

0.3mm Pitch 5814 Series

0.3mm ピッチ 嵌合高さ 0.6mm SMT
0.3mm Pitch, Stacking Height=0.6mm, SMT

001A-2301-0
002B-2301-0

● Plug

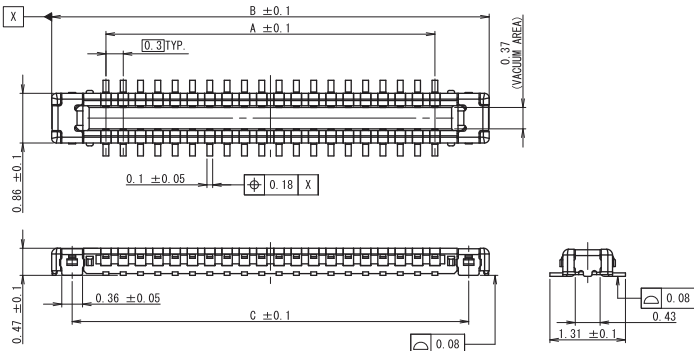

● Receptacle

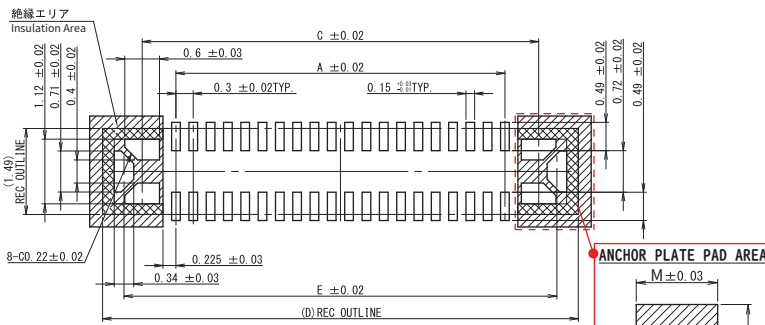
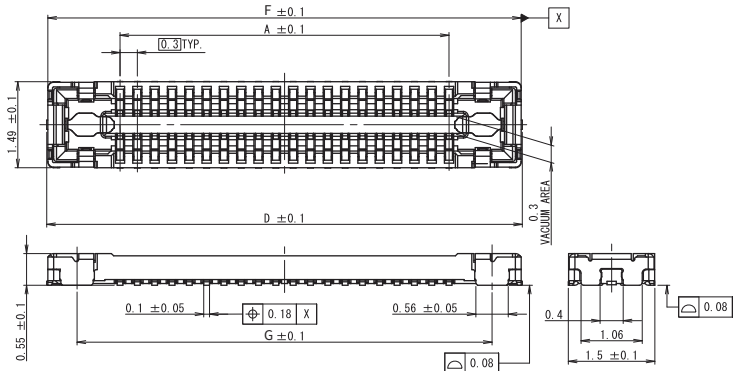

MOUNTING LAYOUT

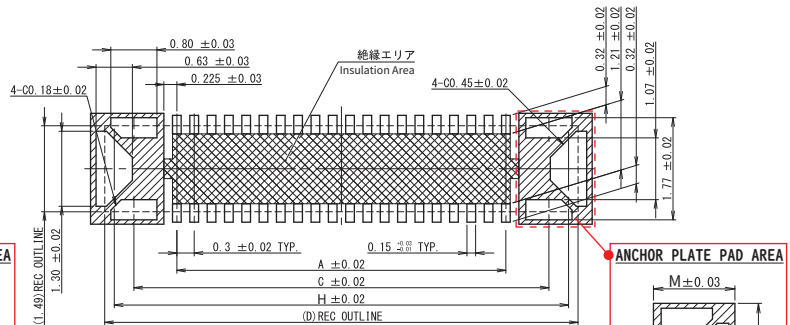

MOUNTING LAYOUT

ANCHOR PLATE PAD AREA

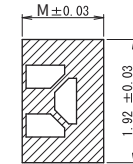

電流 Current	M
3A通電時	1.27
5A通電時	2.70

ANCHOR PLATE PAD AREA

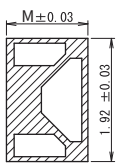

電流 Current	M
3A通電時	1.27
5A通電時	2.70

● Packaging

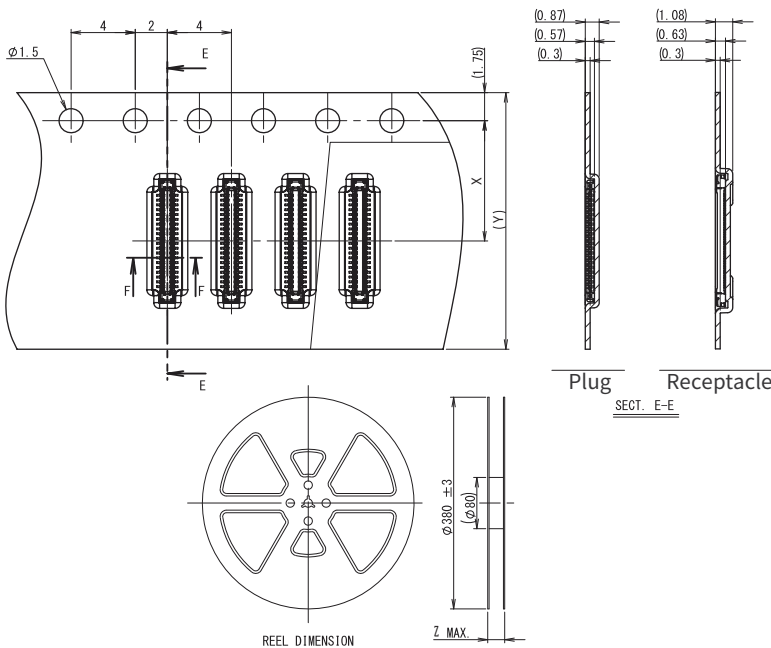

極数 No. OF POS.	A	B	C	D	E	F	G	H	X	Y	Z
10	1.2	3.08	2.37	3.74	3.0	3.7	2.69	3.37	5.5	12	18.4
12	1.5	3.38	2.67	4.04	3.3	4.0	2.99	3.67	5.5	12	18.4
14	1.8	3.68	2.97	4.34	3.6	4.3	3.29	3.97	7.5	16	22.4
16	2.1	3.98	3.27	4.64	3.9	4.6	3.59	4.27	7.5	16	22.4
18	2.4	4.28	3.57	4.94	4.2	4.9	3.89	4.57	7.5	16	22.4
20	2.7	4.58	3.87	5.24	4.5	5.2	4.19	4.87	7.5	16	22.4
22	3.0	4.88	4.17	5.54	4.8	5.5	4.49	5.17	7.5	16	22.4
24	3.3	5.18	4.47	5.84	5.1	5.8	4.79	5.47	7.5	16	22.4
26	3.6	5.48	4.77	6.14	5.4	6.1	5.09	5.77	7.5	16	22.4
28	3.9	5.78	5.07	6.44	5.7	6.4	5.39	6.07	7.5	16	22.4
30	4.2	6.08	5.37	6.74	6.0	6.7	5.69	6.37	7.5	16	22.4
32	4.5	6.38	5.67	7.04	6.3	7.0	5.99	6.67	7.5	16	22.4
34	4.8	6.68	5.97	7.34	6.6	7.3	6.29	6.97	7.5	16	22.4
36	5.1	6.98	6.27	7.64	6.9	7.6	6.59	7.27	7.5	16	22.4
38	5.4	7.28	6.57	7.94	7.2	7.9	6.89	7.57	7.5	16	22.4
40	5.7	7.58	6.87	8.24	7.5	8.2	7.19	7.87	7.5	16	22.4
42	6.0	7.88	7.17	8.54	7.8	8.5	7.49	8.17	11.5	24	30.4
44	6.3	8.18	7.47	8.84	8.1	8.8	7.79	8.47	11.5	24	30.4
46	6.6	8.48	7.77	9.14	8.4	9.1	8.09	8.77	11.5	24	30.4
48	6.9	8.78	8.07	9.44	8.7	9.4	8.39	9.07	11.5	24	30.4
50	7.2	9.08	8.37	9.74	9.0	9.7	8.69	9.37	11.5	24	30.4

注文コード Ordering Code

Part No. X4 5814 OXX 000 329+

1: Plug
2: Receptacle

RoHS 対応品
RoHS Compliant Product

極数数量: 15,000 個 / リール
PACKING QUANTITY: 15,000/Reel

本カタログには推奨めっきを掲載しております。めっき種類・仕様、ならびに生産対応可能極数については営業部に確認願います。
Recommended plating types are mentioned in this catalog. For other plating types and their specifications, and available numbers of positions, please feel free to contact our sales department.