

\* Click the series number to check the product information

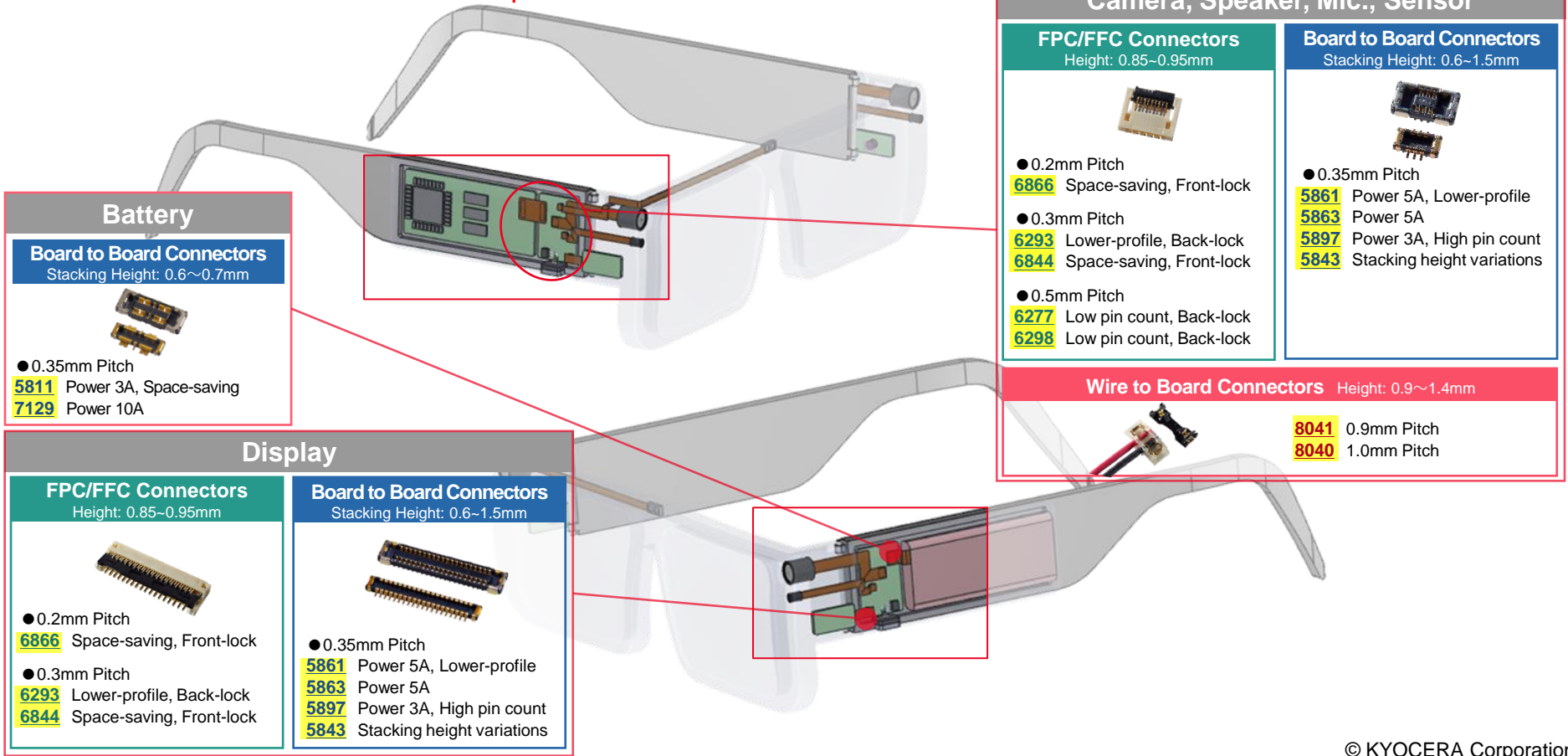

### Battery

**Board to Board Connectors**  
Stacking Height: 0.6~0.7mm

- 0.35mm Pitch
- 5811** Power 3A, Space-saving
- 7129** Power 10A

### Display

**FPC/FFC Connectors**  
Height: 0.85~0.95mm

- 0.2mm Pitch
- 6866** Space-saving, Front-lock
- 0.3mm Pitch
- 6293** Lower-profile, Back-lock
- 6844** Space-saving, Front-lock

**Board to Board Connectors**  
Stacking Height: 0.6~1.5mm

- 0.35mm Pitch
- 5861** Power 5A, Lower-profile
- 5863** Power 5A
- 5897** Power 3A, High pin count
- 5843** Stacking height variations

### Camera, Speaker, Mic., Sensor

**FPC/FFC Connectors**  
Height: 0.85~0.95mm

- 0.2mm Pitch
- 6866** Space-saving, Front-lock
- 0.3mm Pitch
- 6293** Lower-profile, Back-lock
- 6844** Space-saving, Front-lock
- 0.5mm Pitch
- 6277** Low pin count, Back-lock
- 6298** Low pin count, Back-lock

**Board to Board Connectors**  
Stacking Height: 0.6~1.5mm

- 0.35mm Pitch
- 5861** Power 5A, Lower-profile
- 5863** Power 5A
- 5897** Power 3A, High pin count
- 5843** Stacking height variations

**Wire to Board Connectors** Height: 0.9~1.4mm

- 8041** 0.9mm Pitch
- 8040** 1.0mm Pitch